

Types of Lead Came

What to use

C Section

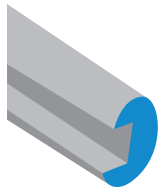

Used for edging your freestanding panels or mirrors - this C Section with a 3mm heart is perfect for more delicate edging work.

Available as:

6 x 3mm

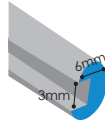

U Section

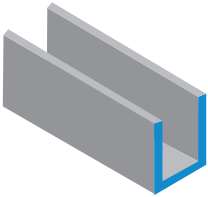

Used for edging your freestanding panels or mirrors - we sell 3 different size types of this lead.

Available as:

5 x 3mm

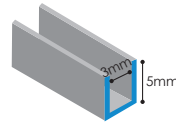

5 x 5mm

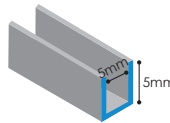

6 x 4mm

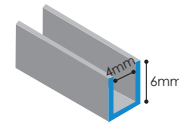

Y Section

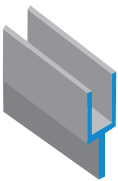

Used as the edging lead for triple glazing stained glass panels, we sell 2 different size types of this lead.

Available as:

6 x 5mm

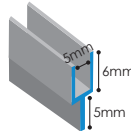

8 x 5mm

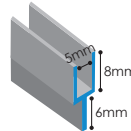

Arrow

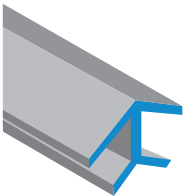

A 90° edging lead used for making 3d stained glass objects such as box lamps.

Available as:

15 x 6mm

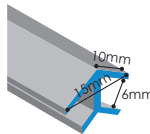

Flat

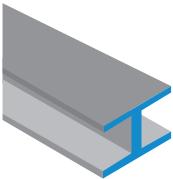

Lead for stained glass work with a flat profile. We sell 9 different size types of this lead.

Available as:

3x4mm



5x5mm



6x5mm



8x5mm



10x5mm



12x5mm*



16x5mm



20x5mm



*Also available as reinforced 12 x 5mm

Round

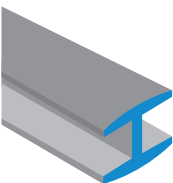

Lead for stained glass work with a rounded profile. Better for leading curved shapes. We sell 8 different size types of this lead.

Available as:

3x4mm



4x5mm



5x5mm



6x5mm



7x5mm



8x5mm



10x5mm



12x5mm



High Heart

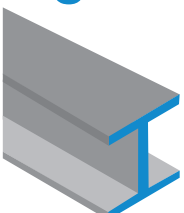

High heart lead comes in flat or rounded profiles and is perfect for plated glass or glass that is irregular in thickness. We sell 5 different size types of this lead.

Available as:

6x7mm round

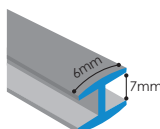

8x7mm flat

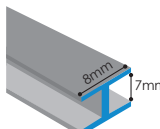

10x7mm round

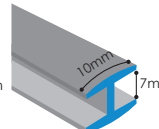

12x7mm flat

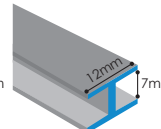

16x7mm flat

